

OPERATING INSTRUCTIONS FOR SAW CHAIN BREAKER

- Read instructions carefully before starting.
- Mount breaker to strong bench with nuts and bolts.
- Wear protection goggles when using the breaker.

HOW TO OPERATE

1. Assembly

Your breaker is already assembled, except the lever. To attach, release screw (1) see diagram 1 and insert lever (2) and tighten screw (1).

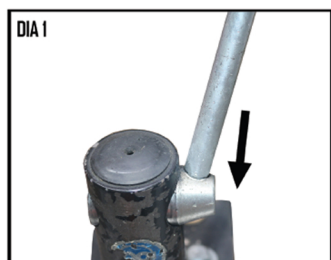

2. Mounting to Bench

Place breaker close to front of your strong bench and fix breaker to bench (see A & B) in diagram 2.

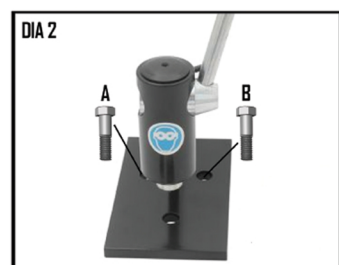

3. How to Break Chain Rivets

Place chain rivet directly under the punch in breaker and pull lever forward with enough force to remove rivet. Ensure punch is centre of rivet. See diagram 4. Place saw chain in the supplied anvil as shown in diagram 3. Tighten anvil with adjustment knob (1).

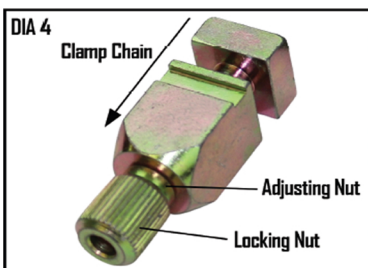
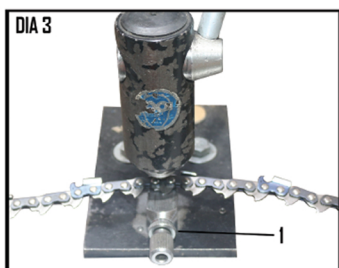

4. Rivet Removal

Make sure cutters are always laying on upside when breaking. See diagram 5 and 6.

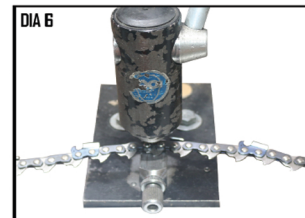
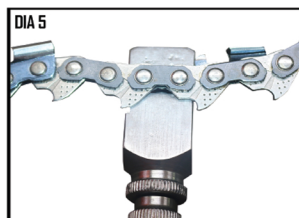

When breaking on a cutter tooth, make sure you align the tooth into the slot as per picture.

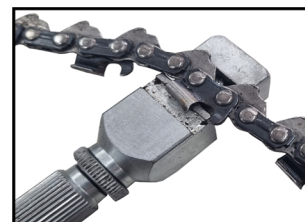

5. How to Replace Punch

To replace broken or worn punch remove grub screw (1) in diagram 7 using the supplied allen key and insert the new punch (2).

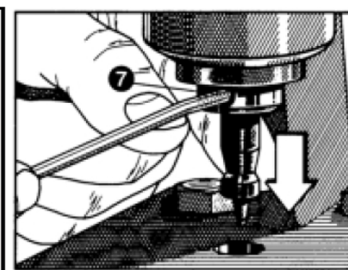



BREAKER-SPINNER

A188 A189

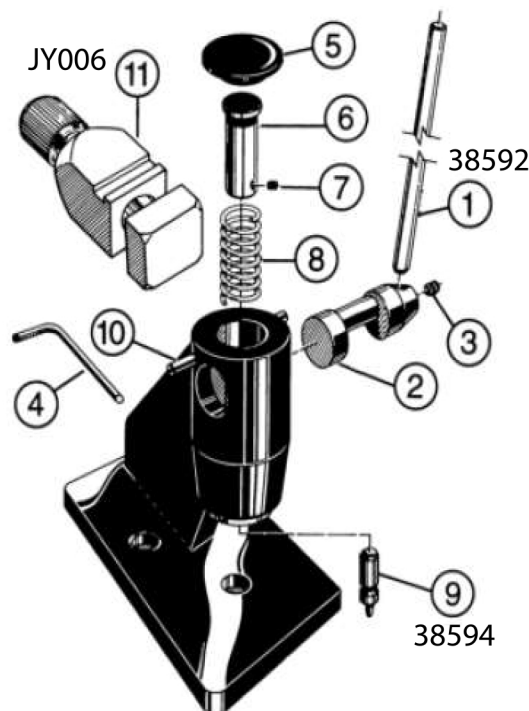
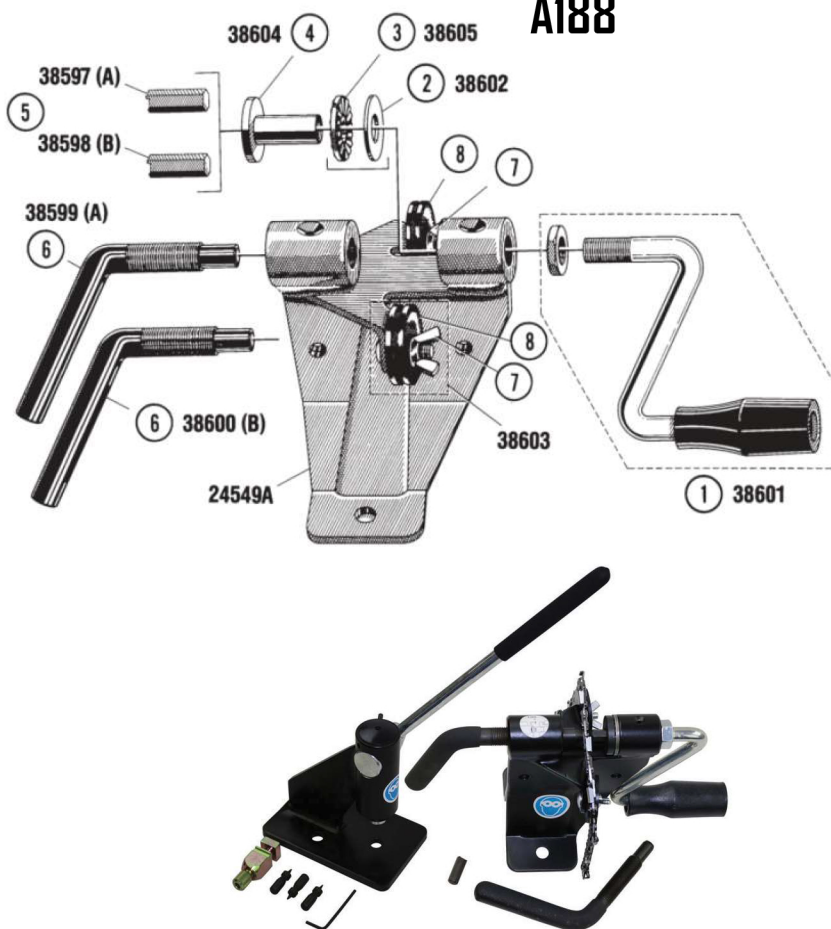

Spinner

JY38599	Thrust Take up Handle (A) 3/8 404 for Chainsaw Chain Rivet spinner
JY38600	Thrust Take up Handle (B) 1/4" .325" for Chainsaw Chain Rivet spinner
JY38604	Spinner Sleeve for Chainsaw Chain Rivet spinner
JY38605	Flat Bearing for Chainsaw Chain Rivet spinner
JY38602	Flat Washer for Chainsaw Chain Rivet spinner
JY38603	Guide Wheel and Locking Screw for Chainsaw Chain Rivet spinner
JY38601	Spinner Handle for Chainsaw Chain Rivet spinner

Breaker

JY38592	Chainsaw Chain Breaker Handle
JY006	Adjustable Anvil Rivet Tool
JY38594	Punch



Scan for video on how to
Break & Spin a chainsaw chain!