

# SMART LOG HORSE

## USER MANUAL

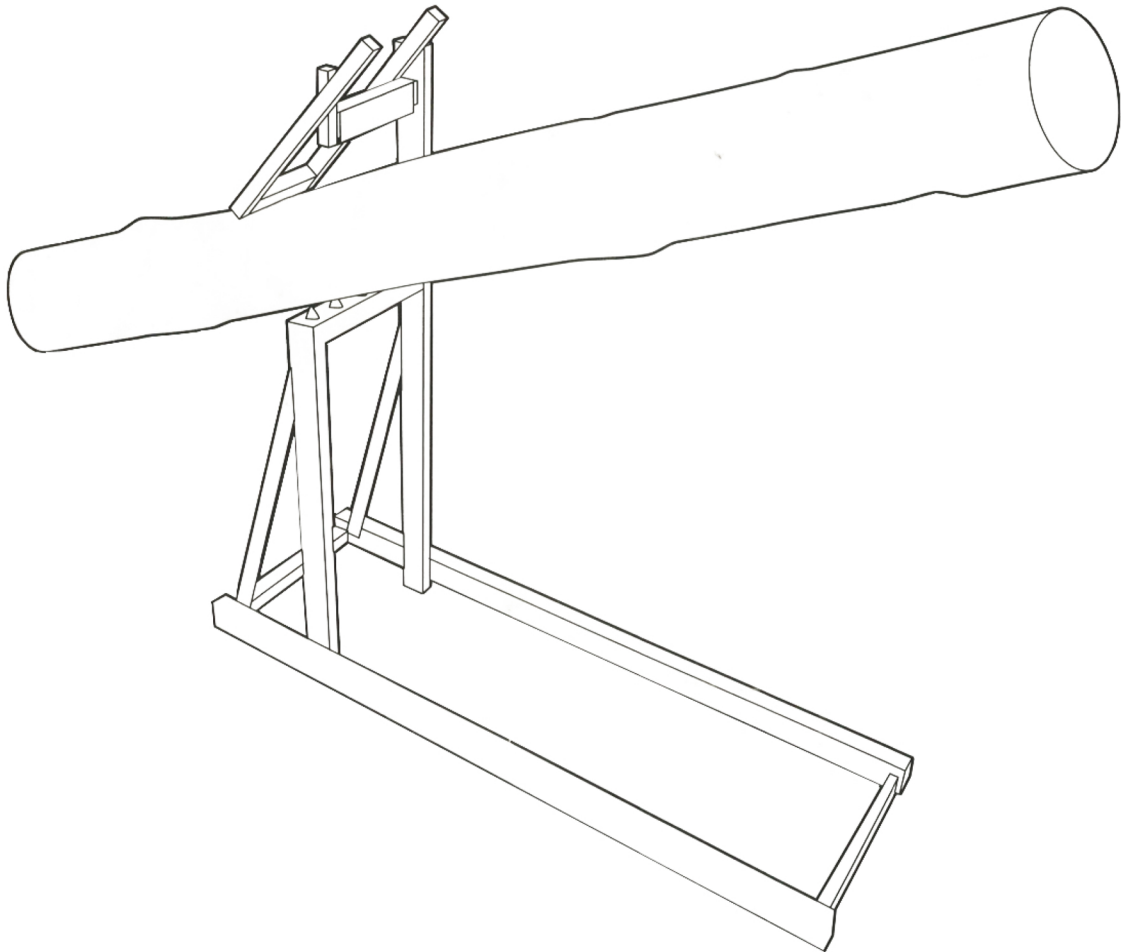

**SKU: SMLH**



**[www.chainsawspares.com.au](http://www.chainsawspares.com.au)**

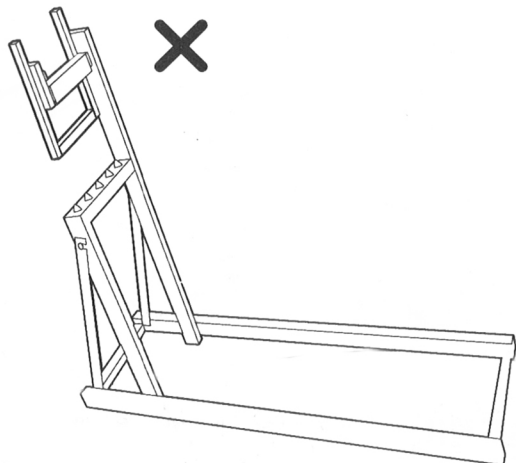
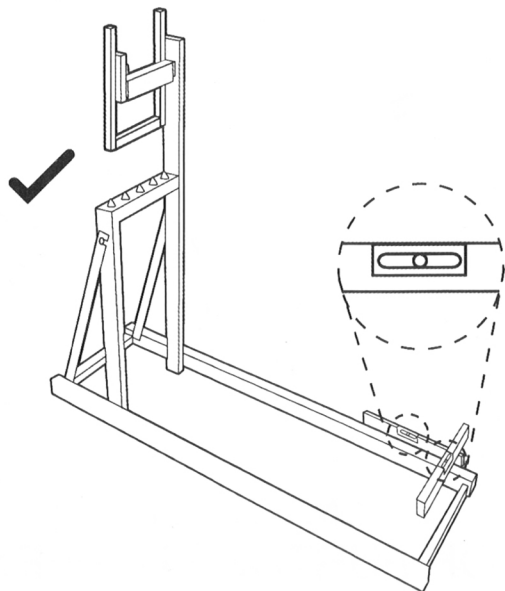
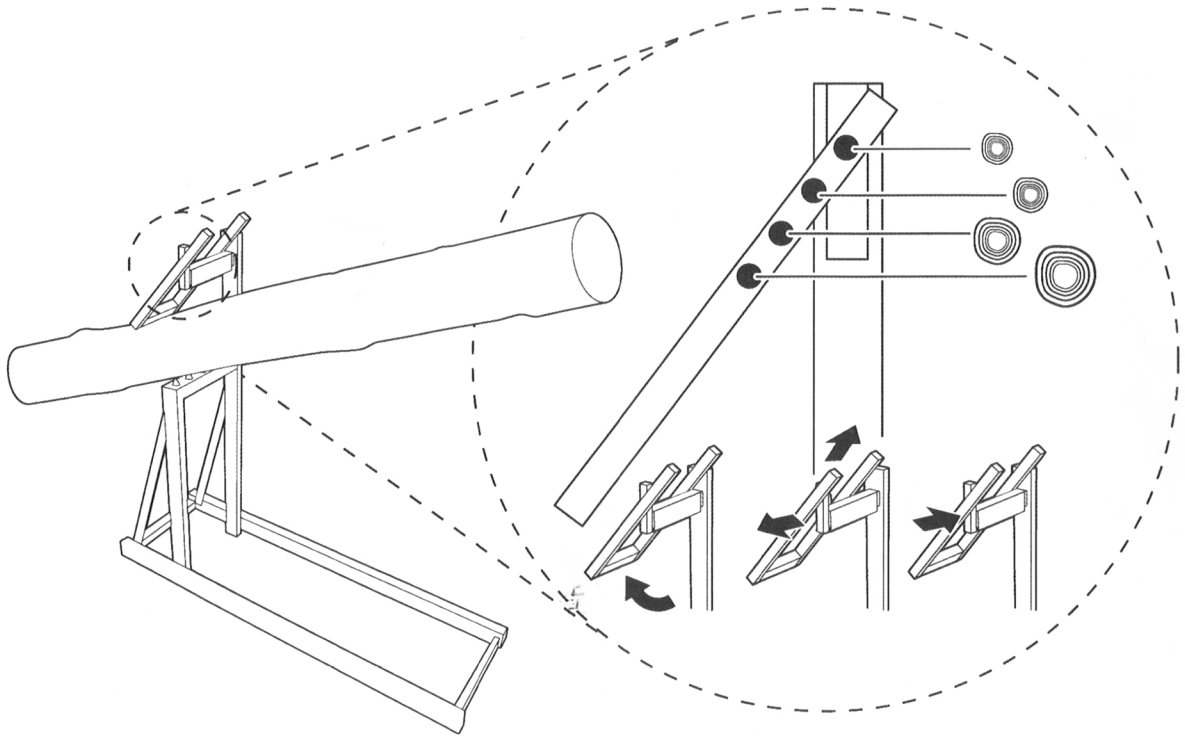
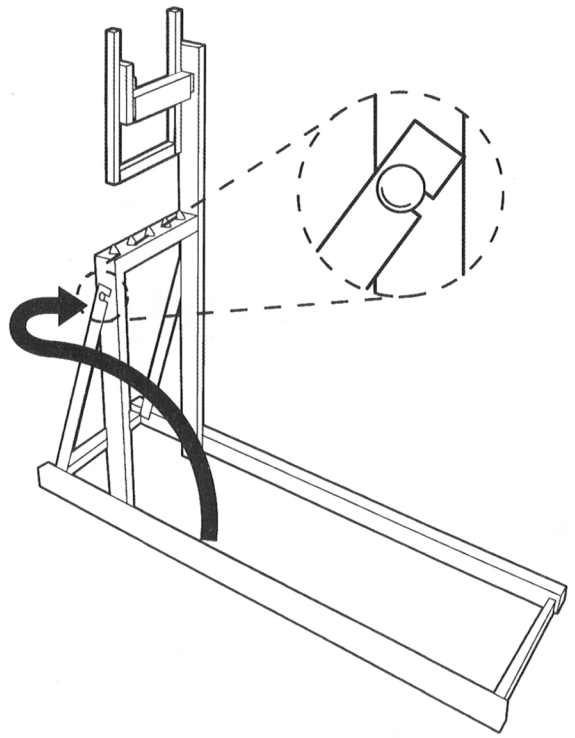
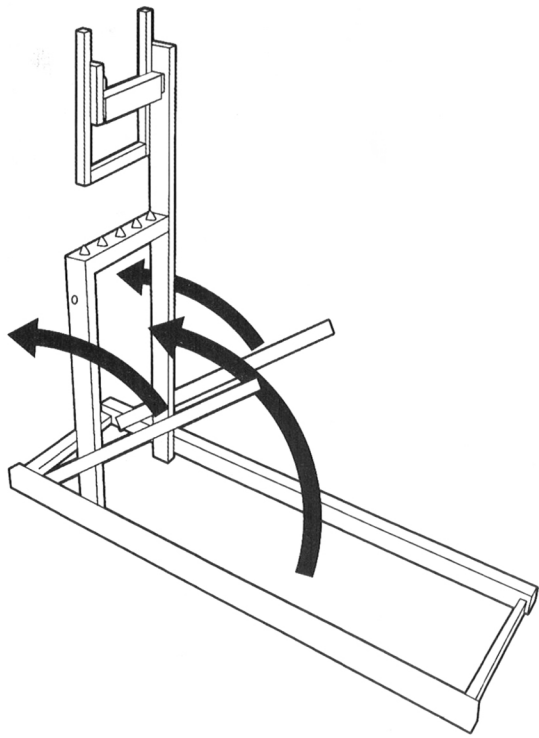

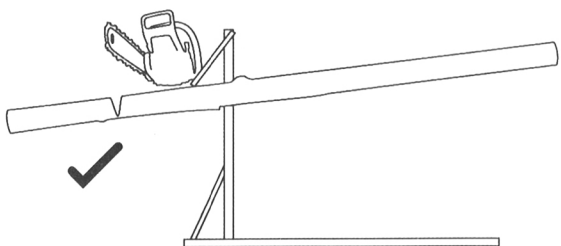
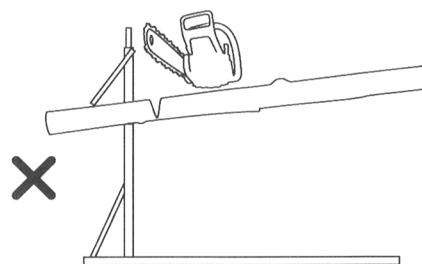
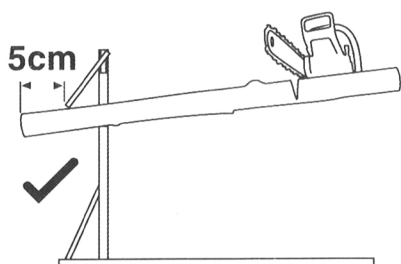
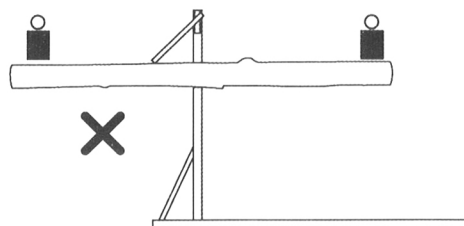
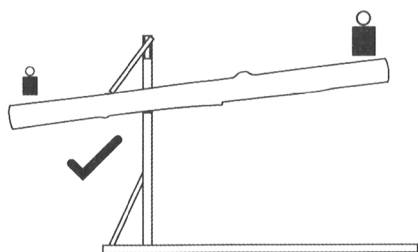
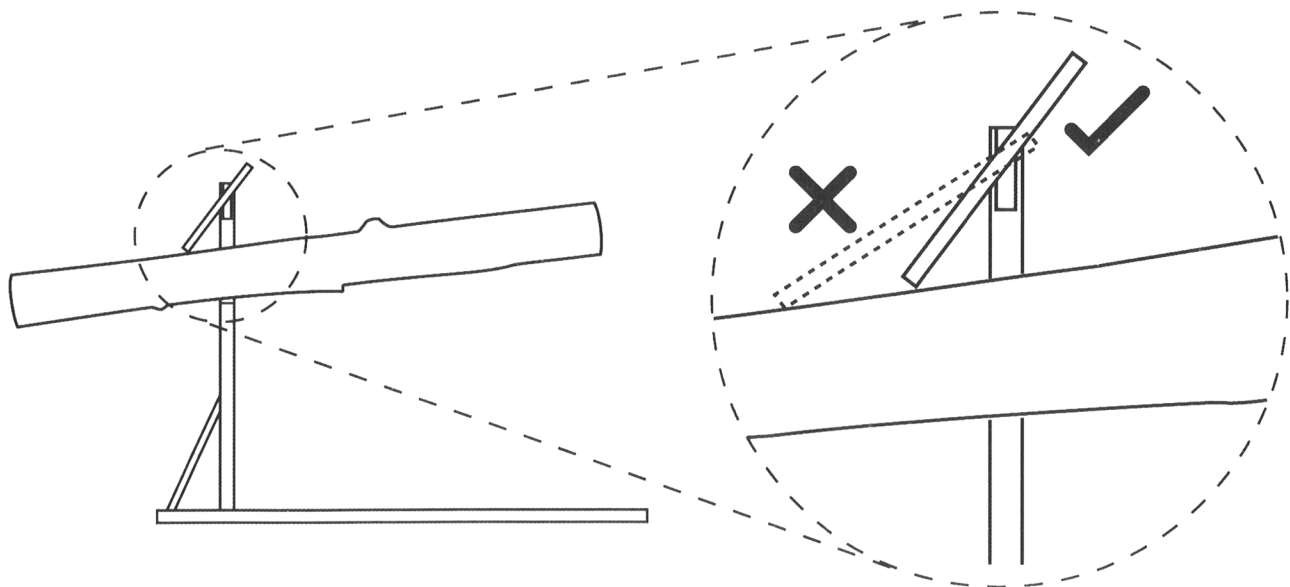

## Safety Precautions

- Observe the operating instructions and the following safety precautions.
- Keep them in a safe place for future reference.
- Non-observance of the precautions may result in serious injury.
- Before using the saw horse, make sure it is complete, properly assembled and not damaged in any way.
- To help avoid accidents, stand the saw horse on firm and level ground only.
- Adjust the swiveling spiked bumper gate (holes) so that the spikes hold the log securely in position.
- After placing the log on the saw horse, check stability and balance, the saw horse must not tilt to one side.
- Read and observe the operating instructions of the chainsaw you are using, pay special attention to the safety precautions.
- Always hold the bumper spike of the chainsaw firmly against the log and only cut with the bottom of the bar (over-bucking) since the log may otherwise shift away from the rotating chain, become unstable and increase the risk of personal injury.

# Exploded Parts View

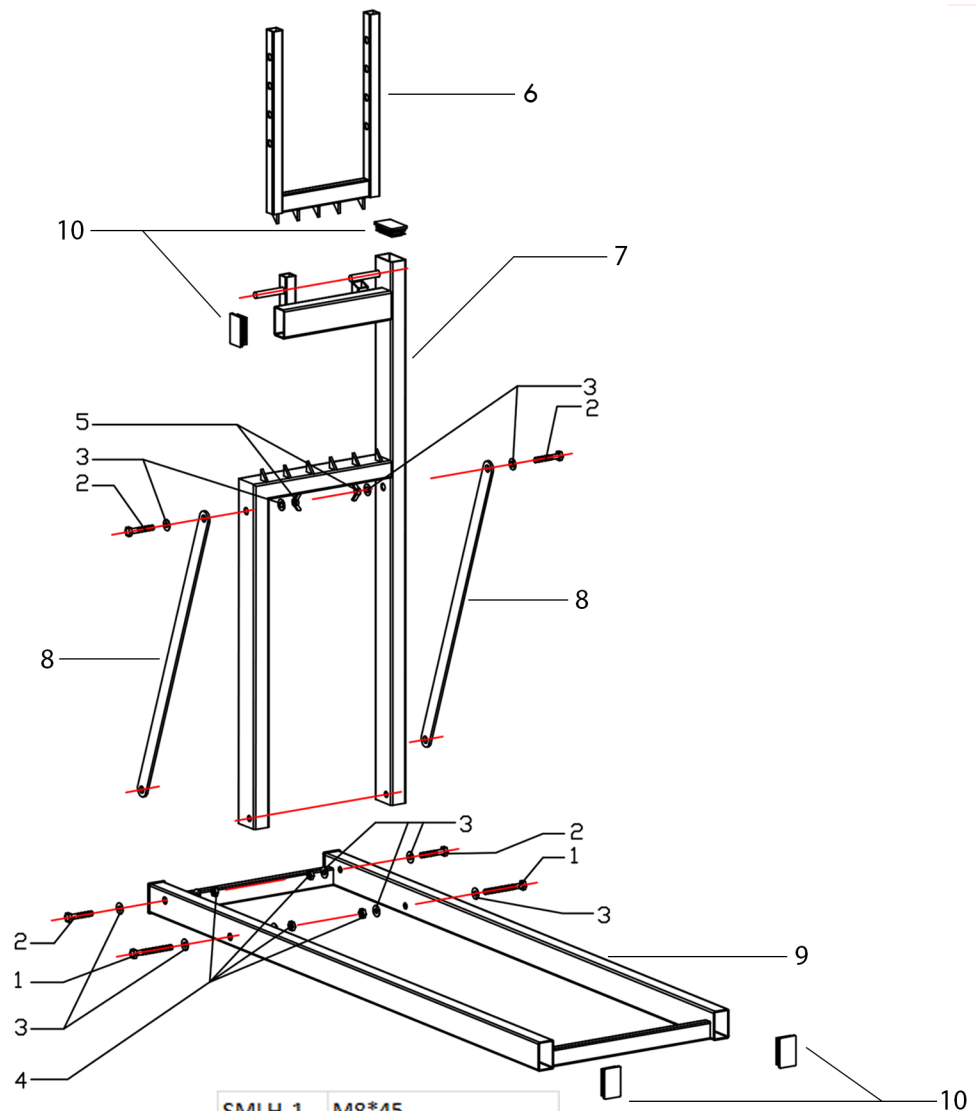

SMLH-1	M8*45
SMLH-2	M8*80
SMLH-3	M8 Washer
SMLH-4	m8 Hex nut
SMLH-5	wing nut
SMLH-6	Top Bracket
SMLH-7	Main Frame
SMLH-8	Supports
SMLH-9	Foot/Bottom Frame
SMLH-10	End Caps

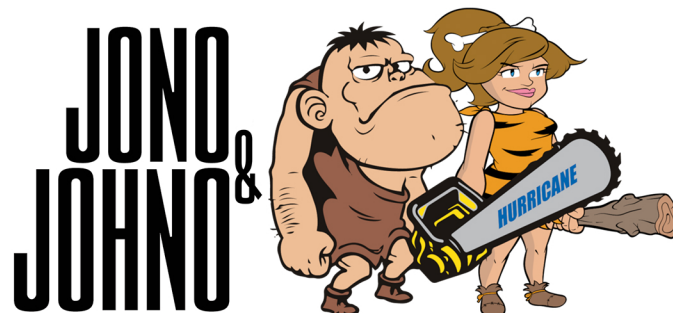

[www.chainsawspares.com.au](http://www.chainsawspares.com.au)