



Original instruction

OPERATOR'S MANUAL

BRUSH CUTTER



Jono & Johnno, 31 Carngham Road, Delacombe, Vic, 3356

Please read the operator's manual carefully and make sure you understand the instructions before using the machine.

CONTENTS

Contents

Contents.....	1
Note the following before starting.....	1

KEY TO SYMBOLS

Symbols on the machine.....	2
Symbols in the operator's manual.....	2
Symbol on the battery and/or on the battery charger.....	2

WHAT IS WHAT?

What is what?.....	3
--------------------	---

GENERAL SAFETY PRECAUTIONS

General power tool safety warnings	4
General power tool safety training	5
Personal protective equipment.....	7
Battery and battery charger.....	7
Machine's safety equipment.....	8
Additional safety instructions for your tool.....	9
Additional safety instructions for battery and charger Battery.....	10

ASSEMBLY

Assembling the Guard Assembly.....	11
Assembling the 3-teeth Blade.....	11
Mounting and adjusting the front-assist handle.....	11
Installing the attachment to the power head.....	11
Assembling the shaft.....	12
Assembling the bike handle.....	12
Power head extensibility.....	12

STARTING AND STOPPING

Check before starting.....	13
Connect battery to the machine.....	13
Starting and stopping.....	13

WORKING TECHNIQUES

Working techniques.....	14
-------------------------	----

MAINTENANCE

General maintenance.....	15
Troubleshooting schedule.....	16
Maintenance schedule.....	17

TECHNICAL DATA

Technical data.....	18
---------------------	----

EC DECLARATION OF CONFORMITY

EC Declaration of Conformity.....	19
-----------------------------------	----

Note the following before starting:

Please read the operator's manual carefully:



WARNING!

Long-term exposure to noise can result in permanent hearing impairment. So always use approved hearing protection.



WARNING!

Under no circumstances may the design of the machine be modified without the permission of the manufacturer. Always use original accessories.

Non-authorized modifications and/or accessories can result in serious personal injury or the death of the operator or others.



WARNING!

A brush cutter is a dangerous tool if used carelessly or incorrectly and can cause serious, even fatal injuries. It is extremely important that you read and understand the contents of this Operator's manual.

INTENDED USE

The brush cutter is intended to cut weed and climbing plants. Do not use it for other purposes, never use it for cutting wood.

Zomax has a policy of continuous product development and therefore reserves the right to modify the design and appearance of products without prior notice. The machine is only designed for blowing lawns, pathways, asphalt roads and the like.

KEY TO SYMBOLS

Symbols on the machine:

Read the instruction manual before using the appliance.

Always wear safety goggles or safety glasses with side shields and a full face shield when operating this product.

Protect your hands with gloves when handling blade or blade guard.
Heavy-duty, nonslip gloves improve your grip and protect your hands.

Wear non-slip safety footwear when using this equipment.

Warn the operator of the danger of blade thrust.

Thrown objects can ricochet and result in personal injury or property damage.
The distance between the machine and bystanders shall be at least 15m.

Do not install round cutting blades.

Do not use in the rain or leave outdoors while it is raining.

In accordance with essential applicable safety standards of European directives.

Type or a characteristic of current

Keypad
• Activate and deactivate

Keypad
• Switch gear

Symbols in the operator's manual:

The machine is turned on and off by pressing the on and stop button. Always remove the battery to prevent the machine being started by accident.

Remove the battery. **IMPORTANT!** Always remove the battery to prevent the machine being started by accident.

Always wear approved protective gloves.

Regular cleaning is required.



Symbol on the battery and/or on the battery charger:

Indicates a potential personal injury hazard.



Please read the operator's manual carefully and make sure you understand the instructions before using the machine.



waste electrical products should not be disposed of with household waste. please recycle where facilities exist. check with your local authority or retailer for recycling advice.



Do not use in the rain or leave outdoors while it is raining.



Do not expose batteries to heat or fire.



Please use and store the battery only in a temperature range between - 10°C and + 50°C.



Use and store battery charger only indoors.



waste electrical products should not be disposed of with household waste. please recycle where facilities exist. check with your local authority or retailer for recycling advice.



WHAT IS WHAT?

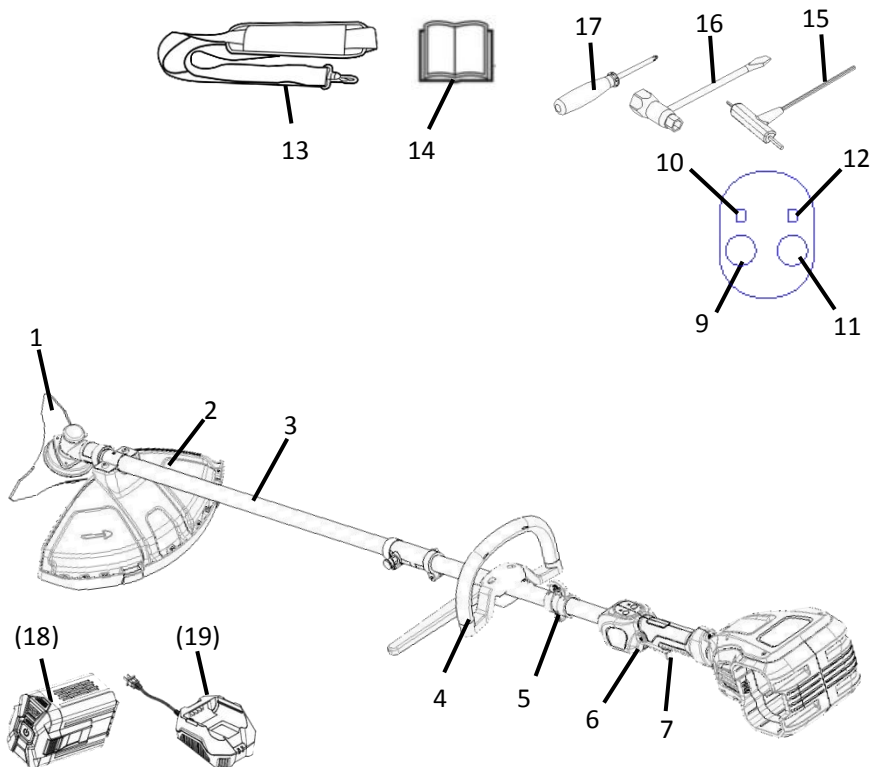

1	3-teeth Blade	11	Switch gear
2	Guard Assembly	12	Gear LED
3	Shaft	13	Shoulder Strap
4	Adjustable Front-Assist Handle	14	Operator's manual
5	Shoulder-Strap Mount	15	Wrench(3-4-5)
6	Lock-off Lever	16	Wrench
7	Trigger	17	Screw driver
8	Bike Handle	18	Battery (Matching)
9	Activate and deactivate	19	Battery charger (Matching)
10	Power LED		

GENERAL SAFETY PRECAUTIONS

General Power tool Safety Warnings



WARNING!

Read all safety warnings and all instructions. Failure to follow the warnings and instructions may result in electric shock, fire and/or serious injury.

Save all warnings and instructions for future reference.

The term "power tool" in the warnings refers to your mains-operated (corded) power tool or battery-operated (cordless) power tool.

1) Work area safety

- a) Keep work area clean and well lit. Cluttered or dark areas invite accidents.
- b) Do not operate power tools in explosive atmospheres, such as in the presence of flammable liquids, gases or dust. Power tools create sparks which may ignite the dust or fumes.
- c) Keep children and bystanders away while operating a power tool. Distractions can cause you to lose control.

2) Electrical safety

- a) Power tool plugs must match the outlet. Never modify the plug in any way. Do not use any adapter plugs with earthed (grounded) power tools. Unmodified plugs and matching outlets will reduce risk of electric shock.
- b) Avoid body contact with earthed or grounded surfaces, such as pipes, radiators, ranges and refrigerators. There is an increased risk of electric shock if your body is earthed or grounded.
- c) Do not expose power tools to rain or wet conditions. Water entering a power tool will increase the risk of electric shock.
- d) Do not abuse the cord. Never use the cord for carrying, pulling or unplugging the power tool. Keep cord away from heat, oil, sharp edges or moving parts. Damaged or entangled cords increase the risk of electric shock.
- e) When operating a power tool outdoors, use an extension cord suitable for outdoor use. Use of a cord suitable for outdoor use reduces the risk of electric shock.
- f) If operating a power tool in a damp location is unavoidable, use a residual current device (RCD) protected supply. Use of an RCD reduces the risk of electric shock.

3) Personal safety

- a) Stay alert, watch what you are doing and use common sense when operating a power tool. Do not use a power tool while you are tired or under the influence of drugs, alcohol or medication. A moment of inattention while operating power tools may result in serious personal injury.

- b) Use personal protective equipment. Always wear eye protection. Protective equipment such as dust mask, non-skid safety shoes, hard hat, or hearing protection used for appropriate conditions will reduce personal injuries.

- c) Prevent unintentional starting. Ensure the switch is in the off-position before connecting to power source and/or battery pack, picking up or carrying the tool.

Carrying power tools with your finger on the switch or energising power tools that have the switch on invites accidents.

- d) Remove any adjusting key or wrench before turning the power tool on. A wrench or a key left attached to a rotating part of the power tool may result in personal injury.
- e) Do not overreach. Keep proper footing and balance at all times. This enables better control of the power tool in unexpected situations.
- f) Dress properly. Do not wear loose clothing or jewellery. Keep your hair, clothing and gloves away from moving parts. Loose clothes, jewellery or long hair can be caught in moving parts.
- g) If devices are provided for the connection of dust extraction and collection facilities, ensure these are connected and properly used. Use of dust collection can reduce dust-related hazards.

4) Power tool use and care

- a) Do not force the power tool. Use the correct power tool for your application. The correct power tool will do the job better and safer at the rate for which it was designed.
- b) Do not use the power tool if the switch does not turn it on and off. Any power tool that cannot be controlled with the switch is dangerous and must be repaired.
- c) Disconnect the plug from the power source and/or the battery pack from the power tool before making any adjustments, changing accessories, or storing power tools. Such preventive safety measures reduce the risk of starting the power tool accidentally.
- d) Store idle power tools out of the reach of children and do not allow persons unfamiliar with the power tool or these instructions to operate the power tool. Power tools are dangerous in the hands of untrained users.
- e) Maintain power tools. Check for misalignment or binding of moving parts, breakage of parts and any other condition that may affect the power tool's operation. If damaged, have the power tool repaired before use. Many accidents are caused by poorly maintained power tools.
- f) Keep cutting tools sharp and clean. Properly maintained cutting tools with sharp cutting edges are less likely to bind and are easier to control.
- g) Use the power tool, accessories and tool bits etc. in accordance with these instructions, taking into

GENERAL SAFETY PRECAUTIONS

account the working conditions and the work to be performed. Use of the power tool for operations different from those intended could result in a hazardous situation.

5) Service

Have your power tools serviced by a qualified repair person using only identical replacement parts. This will ensure that safety of the power tool is maintained.

6) Battery tool use and care

- Recharge only with the charger specified by the manufacturer. A charger that is suitable for one type of battery pack may create a risk of fire when used with another battery pack.
- Use power tools only with specifically designated battery packs. Use of any other battery packs may create a risk of injury and fire.
- When battery pack is not in use, keep it away from other metal objects, like paper clips, coins, keys, nails, screws or other small metal objects, that can make a connection from one terminal to another. Shorting the battery terminals together may cause burns or a fire.
- Under abusive conditions, liquid may be ejected from the battery; avoid contact.

If contact accidentally occurs, flush with water. If liquid contacts eyes, additionally seek medical help. Liquid ejected from the battery may cause irritation or burns.

7) Special Safety Instructions for Battery packet and Charger

If under extreme conditions any electrolyte could escape from the battery, it's essential to avoid contact with skin. If electrolyte does come into contact with your skin, rinse it off with water. In the event of electrolyte contact with your eyes, it's essential to consult a doctor.

This appliance is not intended for use by persons (including children) with reduced physical, sensory or mental capabilities, or lack of experience and knowledge, unless they have been given supervision or instruction concerning use of the appliance by a person responsible for their safety. Children should be supervised to ensure that they do not play with the appliance.

Before the use of the charger and the battery packet, read the instruction manual for it carefully.

During the charge process, the current used should correspond to the current of the battery charger. Never let moisture, rain or splashed water reach the charging location.

The ambient temperature must not exceed 40°C. Never expose the device to direct insulation. Storage-battery packet, which are defective or damaged or can no longer be recharged, must be disposed of as hazardous waste. Hand them over at a special collection point. Never harm our

environment. Do not throw unusable storage-battery packet away into the domestic waste, into fire or into water.

If the electrical cable is damaged, the wire may only be replaced by the supplier or by his repair workshop. Have repairs carried out only by an authorized specialist only.

Use only storage-battery packet, which have been produced by the original manufacturer.

Always keep the surface of the charger free from dust and dirt.

Insert the battery packet into the charger. Follow the guidelines provided concerning polarity.

Always remove battery packet before working on the machine

When the battery packet is outside the drill, cover the contacts to avoid short circuits (e.g. from tools) Do not throw batteries into water or fire, risk of explosion!

Protect the battery packet from impacts, and don't open it.

Never discharge the battery packet completely and recharge occasionally if not used for a prolonged period.

General power tool safety Training

- Read the instructions carefully. Be familiar with the controls and the correct use of the machine.
- Never allow children or people unfamiliar with these instructions to use the machine. Local regulations can restrict the age of the operator.
- Keep in mind, that the operator or user is responsible for accidents or hazards occurring to other people or their property

Preparation

- Obtain ear protection and safety glasses. Wear them at all times while operating the machine.
- While operating the machine always wear substantial footwear and long trousers. Do not operate the machine when barefoot or wearing open sandals. Avoid wearing clothing that is loose fitting or that has hanging cords or ties.
- Do not wear loose clothing or jewellery that can be drawn into the air inlet. Keep long hair away from the air inlets.
- Operate the machine in a recommended position and only on a firm, level surface.
- Do not operate the machine on a paved or gravel surface where ejected material could cause injury.
- Before using, always visually inspect to see fasteners are secure, the housing is undamaged and that guards and screens are in place. Replace worn or damaged components in sets to preserve balance. Replace damaged or unreadable labels.
- Never operate the machine while people, especially children, or pets are nearby.

GENERAL SAFETY PRECAUTIONS



WARNING!

Read all safety warnings and all instructions. Failure to follow the warnings and instructions may result in electric shock, fire and/or serious injury.

IMPORTANT! Save all warnings and instructions for future reference.

Please read the operator's manual carefully and make sure you understand the instructions before using the machine.

Check before starting

- Inspect the working area. Remove all loose objects, such as stones, broken glass, nails, steel wire, string, etc. that could be thrown out.
- Always remove the battery to prevent the machine being started by accident. Always remove the battery before any maintenance on the machine.
- Before using the machine and after any impact, check for signs of wear or damage and repair as necessary.
- Only use original spare parts.
- The machine operator must ensure that no people or animals come closer than 15 metres while working. When several operators are working in the same area the safety distance should be at least 15 metres.
- Carry out an overall inspection of the machine before use. See the maintenance schedule.

Personal safety

- Stay alert, watch what you are doing and use common sense when operating a power tool. Do not use a power tool while you are tired or under the influence of drugs, alcohol or medication. A moment of inattention while operating power tools may result in serious personal injury.
- Keep bystanders away.
- This appliance is not intended for use by person (including children) with reduced physical, sensory or mental capabilities, or lack of experience and knowledge, unless they have been given supervision or instruction concerning use of the appliance by a person responsible for their safety. Children should be supervised to ensure that they do not play with the appliance.
- Never allow children or other persons not trained in the use of the machine and/or the battery to use or service it. Local laws may regulate the age of the user.
- Keep unauthorised persons at a distance. Children, animals, onlookers and helpers should be kept outside the safety zone of 15 metres. Stop the machine immediately if anyone approaches.

- Store the equipment in a lockable area so that it is out of reach of children and unauthorized persons.
- Dress properly. Do not wear loose clothing or jewellery. Keep your hair, clothing and gloves away from moving parts. Loose clothes, jewellery or long hair can be caught in moving parts.
- Never use the machine if you are tired, if you have drunk alcohol, or if you are taking medication that could affect your vision, your judgement or your co-ordination.
- Wear personal protective equipment. See instructions under the "Personal protective equipment" heading.
- Always remove the battery when passing the machine to another person.
- Keep in mind that it is you, the operator that is responsible for not exposing people or their property to accidents or hazards.

Power tool use and care

- Never use a machine that has been modified in any way from its original specification. Never use the machine near explosive or flammable materials.
- Never use a machine that is faulty. Carry out the safety checks, maintenance and service instructions described in this manual. Some maintenance and service measures must be carried out by trained and qualified specialists. See instructions under the Maintenance heading.
- Only use original spare parts.
- Always ensure that ventilation openings are kept clear of debris.
- All covers, guards and handles must be fitted before starting.
- Only use the machine in daylight or in other well-lit conditions.
- Never use the machine in bad weather, for instance in fog, in rain, damp or in wet locations, strong winds, intense cold, risk of lightning, etc. Extremely hot weather may cause overheating of the machine.
- If the machine starts vibrating abnormally, stop the machine and remove the battery.
- Walk, never run.
- Keep proper balance and footing at all times. Do not overreach. Never stand at a higher level than the base of the machine when feeding material into it.

Always use common sense

It is not possible to cover every conceivable situation you can face. Always exercise care and use your common sense. Avoid all situations which you consider to be beyond your capability. If you still feel uncertain about operating procedures after reading these instructions, you should consult an expert before continuing.

GENERAL SAFETY PRECAUTIONS

WARNING!

This machine produces an electromagnetic field during operation. This field may under some circumstances interfere with active or passive medical implants. To reduce the risk of serious or fatal injury, we recommend persons with medical implants to consult their physician and the medical implant manufacturer before operating this machine.



WARNING!

Never allow children to use or be in the vicinity of the machine. Since the machine is easy to start, children may be able to start it if they are not kept under full surveillance. This can mean a risk of serious personal injury. Therefore disconnect the battery when the machine is not under close supervision.



Personal protective equipment

IMPORTANT! A brush cutter is a dangerous tool if used carelessly or incorrectly and can cause serious, even fatal injuries. It is extremely important that you read and understand the contents of this Operator's manual.

You must use approved personal protective equipment whenever you use the machine. Personal protective equipment cannot eliminate the risk of injury but it will reduce the degree of injury if an accident does happen. Ask your dealer for help in choosing the right equipment.



WARNING!

Listen out for warning signals or shouts when you are wearing hearing protection. Always remove your hearing protection as soon as the motor stops.

Hearing protection

Wear hearing protection that provides adequate noise reduction.



Eye protection

Always wear approved eye protection. If you use a

visor then you must also wear approved protective goggles. Approved protective goggles must comply with the ANSI Z87.1 standard in the USA or EN 166 in EU countries.



Clothing

Wear clothes made of a strong fabric and avoid loose clothing that can catch on twigs and branches. Always wear heavy, long pants. Do not wear jewellery, shorts sandals or go barefoot. Secure hair so it is above shoulder level.

First aid kit

Always have a first aid kit nearby.



Battery and battery charger

This section describes the battery and battery charger safety for your battery product. Only use zomax original batteries for zomax products and only charge them in an original battery QC charger from zomax. The batteries are software encrypted. Use only a zomax Lithium-ion battery in your machine.

Battery safety



The rechargeable zomax Lithium-ion, are exclusively used as a power supply for the relevant zomax cordless appliances. To avoid injury, the battery must not be used as a power source for other devices.



WARNING!

Protect the battery from direct sunlight, heat or open flame.

There is a risk the battery may explode if it is thrown into an open fire. There is a risk of burns and/or chemical burns.



WARNING!

Avoid all skin contact with battery acid. Battery acid may cause skin irritation, burns or corrosive injuries. If you get acid in your eyes, do not rub but flush your eyes with plenty of water for at least 15 minutes. See a doctor. You must wash any exposed skin with copious amounts of water and soap in case of incidental contact.

GENERAL SAFETY PRECAUTIONS

WARNING!

Never connect the battery terminals to keys, coins, screws or other metal as this may short-circuit the battery. Never insert objects into the battery's air vents. Unused batteries must be kept away from metal objects such as nails, coins, jewellery. Do not try to disassemble or crush the battery.



- Use the battery in surroundings where temperatures are between -10 °C and 50 °C.
- Do not expose the battery to microwaves or high pressure.
- Never clean the battery or the battery charger with water.
- Store the battery out of reach of children.
- Protect the battery from rain and wet conditions.
- Do not use damaged or cracked battery.



Battery charger safety



Only use Chargers, zomax QC, for charging the zomax replacement Lithium-ion batteries.



WARNING!

Minimise the risk of electric shock or short circuit as follows:

- **Never insert any object into the charger's cooling slots.**
- **Do not try to dismantle the battery charger.**
- **Never connect the charger terminals to metal objects as this can short circuit the battery charger.**
- **Use approved and intact wall sockets.**



WARNING!

Do not use the battery charger close to corrosive or flammable materials. Do not cover the battery charger. Pull out the plug to the battery charger in the event of smoke or fire. Remember the risk of fire.



- Inspect the product for damage before use.
- Regularly check that the battery charger connection wire is intact and that there are no cracks in it.
- Never carry the battery charger using the cord and never pull out the plug by pulling the cord.
- Keep all cables and extension leads away from water, oil and sharp edges. Make sure the cable is not jammed in doors, fences or the like. Otherwise it can cause the charger to become live.
- Never clean the battery or the battery charger with water.
- The appliance can be used by children aged from 8 years and above and persons with reduced physical, sensory, or mental capabilities or lack of experience and knowledge if they have been given supervision or instruction concerning use of the appliance in a safe way and understand the hazards involved. Children shall not play with the appliance. Cleaning and user maintenance shall not be made by children without supervision.
- If the supply cord is damaged, it must be replaced by the manufacturer, its service agent or similarly qualified persons in order to avoid a hazard.
- When charging, the charger must be placed in a well ventilated area and under a roof to keep out moisture. Use and store battery charger only indoors.
- Don't let your children play with the charger. There is a risk of suffocation on small parts of the battery charger is swallowed.
- Don't use the charger while being under influence of medicine, drugs, alcohol, or while being exhausted, tired or ill.

Do not use:

- a faulty or damaged battery charger or never use a faulty, damaged or deformed battery.

Do not charge:

- non-rechargeable batteries in the battery charger or use them in the machine.
- the battery in the battery charger outdoors.
- the battery in the rain or in wet conditions.
- the battery in direct sunlight.

Machine's safety equipment

This section describes the machine's safety equipment, its purpose, and how checks and maintenance should be carried out to ensure that it operates correctly. See the "What is what?" section to locate where this equipment is positioned on your machine.

The life span or the runtime of the machine can be reduced and the risk of accidents can increase if machine maintenance is not carried out correctly and if service and/or repairs are not carried out professionally. If you need further information please contact your nearest service workshop.

GENERAL SAFETY PRECAUTIONS

IMPORTANT! All servicing and repair work on the machine requires special training. This is especially true of the machine's safety equipment. If your machine fails any of the checks described below you must contact your service agent. When you buy any of our products we guarantee the availability of professional repairs and service. If the retailer who sells your machine is not a servicing dealer, ask him for the address of your nearest service agent.



WARNING!

Never use a machine with faulty safety equipment. The machine's safety equipment must be checked and maintained as described in this section. If your machine fails any of these checks contact your service agent to get it repaired.

Emergency

Familiarise yourself with the use of this product by means of this instruction manual. Memorise the safety directions and follow them to the letter. This will help to prevent risks and hazards.

1. Always be alert when using this product, so that you can recognize and handle risks early. Fast intervention can prevent serious injury and damage to property.
2. Turn the product off and disconnect it from the power supply if there are malfunctions. Have the product checked by a qualified professional and repaired, if necessary, before you operate it again.

Residual risks

Even when the tool is used as prescribed it is not possible to eliminate all residual risk factors. The following hazards may arise in connection with the tool's construction and design:

1. Damage to lungs if an effective dust mask is not worn.
2. Damage to hearing if effective hearing protection is not worn.
3. Health defects resulting from vibration emission if the appliance is being used over longer period of time or not adequately managed and properly maintained.

WARNING! This machine produces an electromagnetic field during operation. This field may under some circumstances interfere with active or passive medical implants. To reduce the risk of serious or fatal injury, we recommend persons with medical implants to consult their physician and

the medical implant manufacturer before operating this machine.

Additional safety instructions for your tool

1. Do not charge appliance in damp or wet locations.
2. Do not use battery-operated appliance in rain.
3. Remove or disconnect battery before servicing, cleaning or removing material from the gardening appliance.
4. Do not dispose of the battery in a fire. The cell may explode. Check with local codes for possible special disposal instructions.
5. Do not open or mutilate the battery. Released electrolyte is corrosive and may cause damage to the eyes or skin. It may be toxic if swallowed.
6. Exercise care in handling batteries in order not to short the battery with conducting materials such as rings, bracelets, and keys. The battery or conductor may overheat and cause burns.
7. Charge only using the charger provided with the tool.
8. Do not place outlet tubes near eyes or ears when operating.
9. Do not cross gravel paths or place the tool on gravel while the tool is switched on.
10. Do not place any objects into the openings and moving parts.
11. Before removing the blow tube, always switch off the tool, remove the battery and allow the tool to run down.
12. Avoid dangerous environment. Do not use appliances in damp or wet location.
13. Keep children away. All visitors should be kept at a distance from work area.
14. Dress properly. Do not wear loose clothing or jewelry. They can be caught in moving parts. Use of protective gloves and substantial footwear is recommended when working outdoors. Wear protective hair covering to contain long hair.
15. Use right appliance. Do not use appliance for any job except that for which it is intended.
16. Do not force appliance. It will do the job better and with less risk of injury at the rate for which it was designed.
17. Do not overreach. Keep proper footing and balance at all times.
18. Stay alert. Watch what you are doing. Use common sense. Do not operate appliance when you are tired.
19. Store idle appliances indoors. When not in use, appliances should be stored indoors in dry, and high or locked-up place, out of reach of children.
20. Check damaged parts. Before further use of the appliance, a guard or other part that is damaged should be carefully checked to determine that it will operate properly and perform its intended function. Check for alignment of moving parts, binding or moving parts, breakage of parts, mounting, and any

GENERAL SAFETY PRECAUTIONS

other condition that may affect its operation. A guard or other part that is damaged should be properly repaired or replaced by an authorized service center unless indicated elsewhere in this manual.

Additional safety instructions for battery and charger Battery

- Never attempt to open for any reason.
- Do not expose to water.
- Do not incinerate the battery pack even if it is severely damaged or is completely worn out. The battery pack can explode in a fire.
- Do not store in locations where the temperature may exceed 40°C.
- Do not leave the battery pack in the charger when the charging is finished, otherwise battery leakage may occur.
- Charge only at room temperature.
- Charge only at using the charger provided with the tool (see technical data).
- Before charging, make sure that the battery is dry and clean.
- Use only the correct type of battery for the tool(see technical data).
- When dispose of batteries follow the instructions given in the section "Disposal".
- Under extreme conditions, battery leakage may occur .When you notice liquid on the battery, proceed as follows.
- Carefully wipe the liquid off using a cloth. Avoid skin contact.
- In case of skin or eye contact, follow the instructions below. The battery fluid, a 25-30% solution of potassium hydroxide, can be harmful. In case of skin contact, immediately rinse with water. Neutralize with a mild acid such as lemon juice or vinegar. In case of eye contact, rinse abundantly with clean water for at least 10 minutes. Consult a physician.

NOTE: The batteries in your battery pack are the Lithium-Ion type. Do not dispose of battery packs/batteries into household waste, fire or water. Battery packs/batteries should be collected, recycled or disposed of in an environmental-friendly manner.

Charger

Charger's plug must match the outlet. Never modify the plug in any way. Unmodified plugs and matching outlets will reduce risk of electric shock.

- Use your charger only to charge batteries of the type supplied with your tool. Other batteries could burst, causing personal injury and damage.
- Only 2 battery packs is allowed to be charged continuously in order to prevent overheating of charger, necessary rest time is required to let the charger cool down before further charging.

- When charging is finished, unplug the charger from mains socket outlet and take away the battery pack from the charger, do not leave the battery pack in the charger.
- Never carry the charger by its cord or pull it to disconnect from the socket. Keep the cord away from heat, oil and sharp edges.
- Never attempt to charge non-rechargeable batteries.
- The cord of charger is not changeable, do not continue to use if the cord is damaged.
- Do not expose to water or rain, do not use in wet condition.
- Do not open the charger.
- Do not probe the charger.
- Intended for indoor use only.

ASSEMBLY



WARNING!

Always remove the battery pack from the product when you are assembling parts, making adjustments, cleaning, or when the product is not in use.

Assembling the Guard Assembly

1. Loosen and remove the two screws from the guard.
2. align the guard mounting holes with the assembly holes and then lock the guard onto the shaft base with the two screws

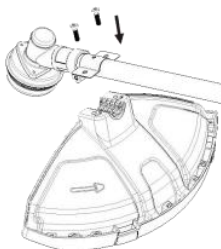
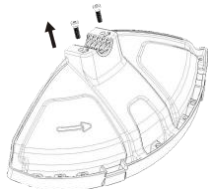

Assembling the 3-teeth Blade

1. Insert the wrench into the aligned holes to act as a stabilizer.
2. Unscrew the nut in a clockwise direction.
3. Pull out blade cover.
4. Install the blade.
5. Refit the blade cover and the nut, fully tightening it in an anticlockwise direction.
6. Remove the wrench.

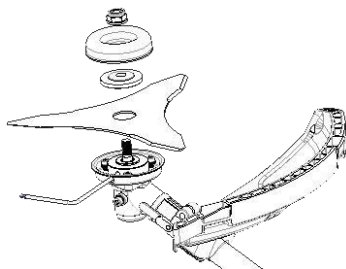

Assembling and adjusting the front-assist handle.

1. Stop the motor and remove the battery pack, if installed.
2. Loosen the two screws in the front-assist handle with the supplied wrench and remove the screws and lower clamp from the front-assist handle.
3. Attach the front-assist handle and lower clamp on the power-head shaft and secure them by pre-tightening the two screws. Turn the front-assist handle upwards so that it points toward the top of the rear handle.
4. Adjust the front-assist handle position between the rear handle housing and the coupler on the power-head shaft.
5. Tighten the two screws so that the handle cannot be rotated on the shaft.

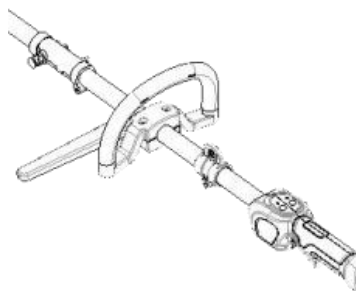
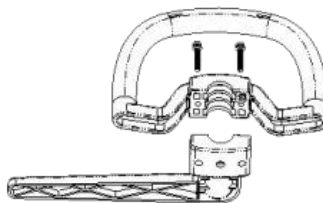

Assembling the attachment to the power head.

1. Stop the motor and remove the battery pack.
2. Loosen the wing knob.
3. Remove the end cap from the attachment. Pull out the shaft-release knob and push the attachment shaft into the coupler until you hear a clear "click" sound, which indicates that the attachment shaft is mounted into place.

ASSEMBLY

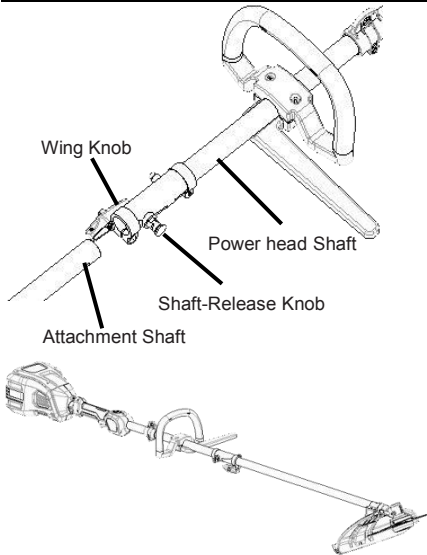

Assembling the shaft

1. Loosen the screw 1 and screw 2.
2. Connect the power head and shaft.
3. Align the hole of the power head and the hole of the shaft, and then tighten the screw 1.
4. Tighten the screw 2.

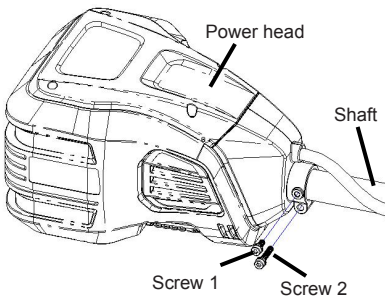

Assembling the bike handle.

1. Loosen the four screws, adjust the bike handle on the shaft, and then tighten the four screws.
2. Clip the lead into the wire holder.

Power head extensibility

The power head of ZMDF512 or ZMDF513 may be used with the following ZOMAX attachments or subsequently introduced by ZOMAX for use with this power head:

ATTACHMENT	TYPE
STRING TRIMMER	ZMST02
POLE SAW	ZMPC02
POLE HEDGE TRIMMER	ZMPH02
LAWN EDGER	ZME01
CULTIVATOR	ZMCT01

STARTING AND STOPPING

Check before starting



- Check the motor for dirt and cracks. Clean off grass and leaves from the engine using a brush. Gloves should be worn when necessary.
- Check that the machine is in perfect working order. Check that all nuts and screws are tight.
- Only use the machine for the purpose it was intended for.

Connect battery to the machine

- Make sure to use fully charged batteries. Use only a Zomax original battery in your machine. See technical data.
- Insert the battery in the machine. The battery should slide easily into the battery holder on the machine. If the battery does not slide in easily, it is not being inserted correctly.

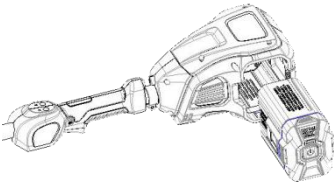

- Press on the lower part of the battery and push it in as far as it will go into the battery compartment. The battery will lock itself into place when you hear a click.

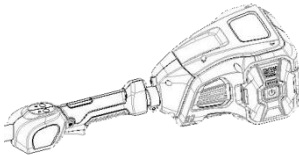

Starting and stopping



WARNING!
Make sure no unauthorised persons are in the working area. Otherwise there is a risk of serious personal injury. The safety distance is 15 meters.

Starting

- Turn on the machine. Press and hold the start button until the LED is lit.

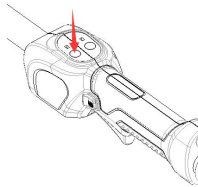

- Press the lock-off button down and hold it in that position. Depress the trigger to turn on the power head. Release the lock-off button and continue to squeeze the trigger for continued operation.

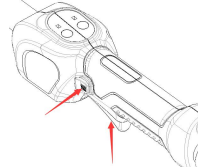

- Press the Switch gear to switch the speed, Led light is high speed, and vice is low speed.

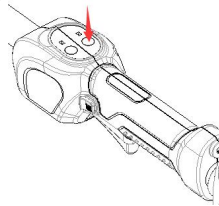

Stopping

- Stop the machine by releasing the throttle and pressing the deactivation button.
- Remove the battery from the machine by pressing the two release buttons and pulling out the battery.

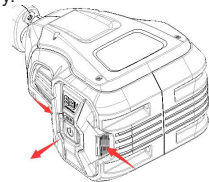

IMPORTANT! Always remove the battery to prevent the machine being started by accident.

WORKING TECHNIQUES

IMPORTANT! This section considers basic safety rules when working with brush cutter. If you encounter a situation where you are uncertain how to proceed you should ask an expert. Contact your dealer or your service workshop. Avoid all usage which you consider to be beyond your capability.



WARNING!

WARNING: Dress properly to reduce the risk of injury when operating the brush cutter. Do not wear loose clothing or jewelry. Wear eye and ear/hearing protection. Wear heavy duty, long trousers, boots and gloves. Do not wear short trousers, sandals or go barefoot. Before operating, look around you to ensure a safety working area without other people, animals or any loose objects. Make sure they are at least 15m away. And then check for eye protection, proper clothing and balanced footing. Before each use check for damaged/worn parts. Check the trimmer head, 3-teeth blade, guard, guard accessory, bike handle and double-shoulder strap and replace any parts that are cracked, warped, bent, or damaged in any way. The line-cutting blade on the edge of the guard accessory can dull over time. It is recommended that you periodically sharpen it with a file or replace it with a new blade. After each use, clean the brush cutter



WARNING!

To cut wild growth and scrub, lower the rotating 3-teeth blade down onto the growth to achieve a chopping effect. Use the brush cutter like a scythe (sweep it to the right and left) at ground level. Do not use the cutting unit above waist height.



WARNING!

The higher the cutting unit is off the ground, the greater the risk of injury from cuttings being thrown sideways.



WARNING!

When cutting young stands or other woody materials up to 2cm in diameter, use the left side of the blade to avoid blade thrust situations. Do not attempt to cut woody material with a larger diameter, since the blade may catch or jerk the brush cutter forward. This may cause damage to the blade or the brush cutter or loss of control of the brush cutter, resulting personal injury.



WARNING!

Improper use of a blade may cause it to crack, chip, or shatter. Thrown parts may seriously injure the operator or bystander. To reduce the risk of personal injury, it is essential to take the following precautions:

- Avoid contact with hard or solid foreign objects such as stones, rocks or pieces of metal.
- Never cut wood or shrubs with a stem diameter of more than 2cm.
- Inspect the blade at a regular short interval for signs of damage. Do not continue working with a damaged blade.
- Re-sharpen the blade regularly (when it has dulled noticeably) and have it balanced if necessary
- (performed by a qualified service technician).

MAINTENANCE



WARNING!

Before inspecting, cleaning or servicing the unit, stop the motor, wait for all moving parts to stop, and remove the battery pack. Failure to follow these instructions can result in serious personal injury or property damage.



WARNING!

When servicing, use only identical replacement parts. Use of any other parts may create a hazard or cause product damage. To ensure safety and reliability, all repairs should be performed by a qualified service technician.

GENERAL MAINTENANCE

Avoid using solvents when cleaning plastic parts. Most plastics are susceptible to damage from various types of commercial solvents and may be damaged by their use. Use clean clothes to remove dirt, dust, oil, grease, etc.

- After each use of 3-teeth blade / trimmer head, clean the debris, clogged soils or grass on the blade and guard with a soft brush.

NOTICE: When the line-cutting blade becomes dull, please sharpen it performed by a qualified service technician or replace with a new line-cutting blade as necessary.

- After each use of brush cutter, clean the cutting unit using a damp cloth with a mild detergent.
- Do not use any strong detergents on the plastic housing or the handle. They can be damaged by certain aromatic oils, such as pine and lemon, and by solvents such as kerosene. Moisture can also cause a shock hazard. Wipe off any moisture with a soft dry cloth.
- Use a small brush or a small vacuum cleaner to clean the air vents on the rear housing.

STORING THE MACHINE

- Remove the battery pack from the tool.
- Wear heavy gloves to clean the tool thoroughly.
- Mount the blade sheath onto the 3-teeth blade for safe saving.
- Store the unit in a dry, well-ventilated area, locked-up or up high, out of the reach of children.
- Do not store the machine on or adjacent to fertilizers, gasoline, or other chemicals.

Protecting the environment



Do not dispose of electrical equipment, battery charger and batteries/ rechargeable batteries into household waste!

According to the European law 2012/19/ EU, electrical and electronic equipment that is no longer usable, and according to the European law 2006/66/EC, defective or used battery packs/batteries, must be collected separately.

If electrical appliances are disposed of in landfills or dumps, hazardous substances can leak into the groundwater and get into the food chain, damaging your health and well-being.

MAINTENANCE

Troubleshooting schedule Keypad

Keypad	Possible faults	Possible action
Slow flashing.	Low battery voltage.	Charging the battery
	Temperature deviation.	Allow the machine to cool down.
Rapid flashing.	short trouble.	Restart or Contact your service agent.
Two flash and one stop	Communication is not normal.	replace the battery or contact your service agent.
	Battery pack overheat protection	Cool down
Three flash and one stop	Temperature deviation	Cool down
Four flash and one stop	Over current protection	Check the machine to see if there is a plug. If there is, remove the plug.
Five flash and one stop	Open phase protection	Contact your service agent.
	Locked-rotor protection	Check the machine to see if there is a plug. If there is, remove the plug.
The power LED light is not bright.	The way that battery connected to the machine is faulty.	Pull out the battery plugged back or replace the battery.
	Dirt in battery connectors.	Clean with compressed air or a soft brush.
	Service	Contact your service agent.

Battery

LED display	Possible faults	Possible action
Green activate LED flashing.	Low battery voltage.	Charge the battery.
Four green light flashing.	Under voltage.	Remove the battery from the battery charger.
	Temperature deviation	Use the battery in surroundings where temperatures are between -10°C and 50 °C.
	Over voltage.	Check that the mains voltage corresponds with that stated on the rating plate on the machine.
The red light flashing	Communication is not normal.	Remove the battery from the battery charger.
The red light lit	Battery pack damage	Contact your service agent.

Battery charger

LED display	Possible faults	Possible action
GREEN LED and RED LED flashing.	Temperature deviation.	Use the battery charger only when the surrounding temperature is between 0°C and 50 °C.
RED LED flashing.	Over current or Defective battery.	If defective, try to repeat the conditions a second time by removing and reinstalling the battery pack.If the LED status repeats a second time, try charging a different battery.
		If a different battery charges normally, dispose of the defective pack (see battery pack operator's manual).
		If a different battery also indicates "Defective," the charger may be defective.

MAINTENANCE

Maintenance schedule

- When the machine is stopped for servicing, inspection, or storage, shut off the power source, disconnect the machine from the supply and make sure that all moving parts are come to a complete stop. Allow the machine to cool before making any inspections, adjustments, etc. Maintain the machine with care and keep it clean.
- Store the machine in a dry place out of the reach of children.
- Always allow the machine to cool before storing.
- Never attempt to override the interlocked feature of the guard.



WARNING!

Always remove the battery before any maintenance on the machine.

The following is a list of the maintenance steps that must be performed on the machine. Most of the items are described in the Maintenance section. The user must only carry out the maintenance and service work described in this Operator's Manual. More extensive work must be carried out by an authorized service workshop.

Maintenance	Daily maintenance	Weekly maintenance	Monthly maintenance
Clean the outside of the machine with a clean and dry cloth. Never use water.	X		
Keep the handle dry and free of grease and oil.	X		
Make sure that the activate and deactivate button works correctly and is not damaged.	X		
Make sure the throttle is functioning properly with regard to safety.	X		
Check that nuts and screws are tight.	X		
Check that the battery is intact.	X		
Check the battery's charge.	X		
Check that the release buttons on the battery works and locks the battery into the machine.	X		
Check that the battery charger is intact and functional.	X		
Check that all couplings, connections and cables are intact and free from dirt.		X	
Check the connections between the battery and the machine and also check the connection between battery and the battery charger.			X

N O T E S

EC DECLARATION OF CONFORMITY

EC DECLARATION OF CONFORMITY

Herewith we,

Manufacturer: By Zhejiang Zomax Garden Machinery Co., Ltd. for Jono & Johno

Address: 31 Carngham Road, Delacombe, Vic, 3356

Designation: brush cutter

Model/Type:ZMDG5122P/ZMDG5121U/ZMDG5121P/ZMDG5122U/ZMDF512/ZMDG5131U/ZMDG5132P/ZMDG5131P/ZMDG5132U/ZMDF513

correspond with the applicable EU directives

2006/42/EC, 2014/30/EU

and are manufactured in accordance with the following standards or standardized documents:

EN 60745-1:2012+A11+A13, **ISO11806**:2011, EN 62233:2008, EN 55014-1:2006+A1, EN 55014-2:1997+A1+A2, EN 61000-3-2:2006+A1+A2, EN 61000-3-3:2008

Additionally confirmed by the Directive 2000/14/EC Noise emission:

Sound power level:

Measured: 92.93dB(A)

Guaranteed: 96dB (A)

Applied conformity assessment according to Annex VI / 2000/14/EC and 2005/88/EC

The technical documentation is kept by our authorized representative

EUROMATE GmbH

Emil- Lux- Straße 1, D-42929 Wermelskirchen, Germany